

Molded Fittings

Tee - Socket Fusion

For Information Call (713) 645-2858
or fax (713) 645-1756

1/2" CTS - 4" IPS Sizes
PE 3408 in Stock, PE 2406 on Request
Conforms to ASTM D2513
CSA Certified, ISO 9003-1987

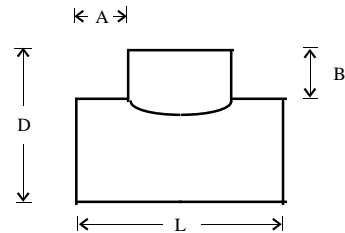

Nom. Pipe Size	Box Qty	Stock	Dim. A	Dim. B	Dim. D	Dim. L	Box Weight	Part Number
1/2 CTS	10	n	5/8	5/8	1-5/8	2-3/8	0.5	SPECIAL
3/4 CTS	10	n	3/4	3/4	1-7/8	2-7/8	0.9	SPECIAL
1 CTS	10	n	3/4	3/4	2-1/4	3-1/8	1.3	SPECIAL
1/2 IPS	10	n	3/4	3/4	1-7/8	2-5/8	0.9	FS005FHT0050S
3/4 IPS	10	n	7/8	7/8	2-1/4	3-3/8	1.3	FS007FHT0070S
1 IPS	10	n	7/8	7/8	2-1/4	3-1/4	2.4	FS010FHT0100S
1-1/4 IPS	10	n	1	1	2-3/4	4-1/4	4.1	FS012FHT0120S
1-1/2 IPS	10	n	1	1	3-1/2	4-3/8	5.9	FS015FHT0150S
2 IPS	10	y	1-1/4	1-1/4	4-1/2	5-3/4	10.8	FS020FHT0200S
3 IPS	4	y	1-1/2	1-1/2	6	7-1/2	12.9	FS030FHT0300S
4 IPS	4	y	2-1/4	2-1/4	7-1/8	10	30	FS040FHT0400S